

**Drilling and milling head, straight, double, adjustable alignment pi  
collet chuck, ER25A, PRECI-FLEX®  
external and central coolant supply**



**Part Number 7.079.450**  
**for Mazak QTN 300/350/400/450 MSY (II)**

Ratio **1:1**  
rpm at Input **max. 6000 rpm**  
rpm at Output **max. 6000 rpm**  
Torque at Output **max. 35 Nm**  
Direction of Rotation   
Scope of Delivery **without wrench and collets**

Accessories Collets see Equipment for Toolholders Z2.1  
Sealing washers see Equipment for Toolholders Z4.1  
Wrench for spindle 0.002.277  
PRECI-FLEX® Adapter  
Spindle cover see P99.1  
Spindle sealing see P99.1  
Coolant tubes 0.000.377

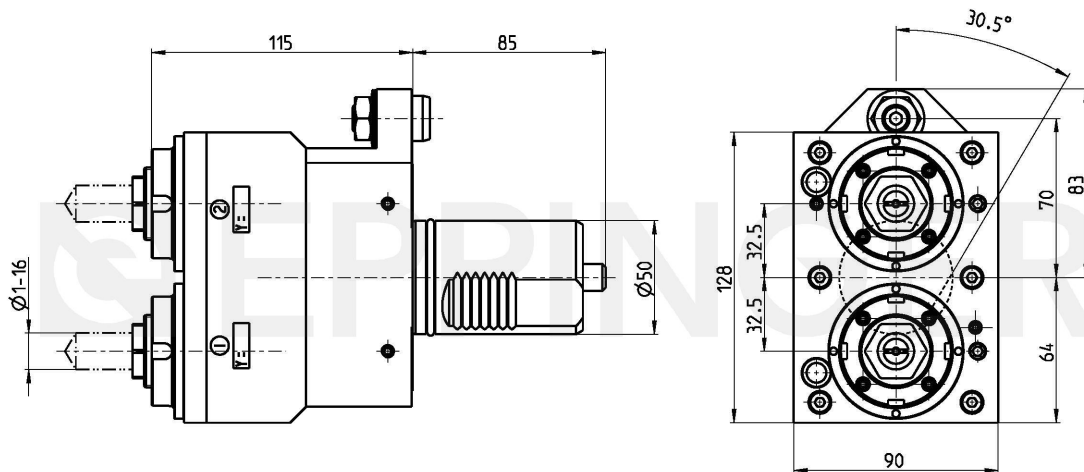

Technical Data Subject to Change

08.06.2015 | 30.01.2023