

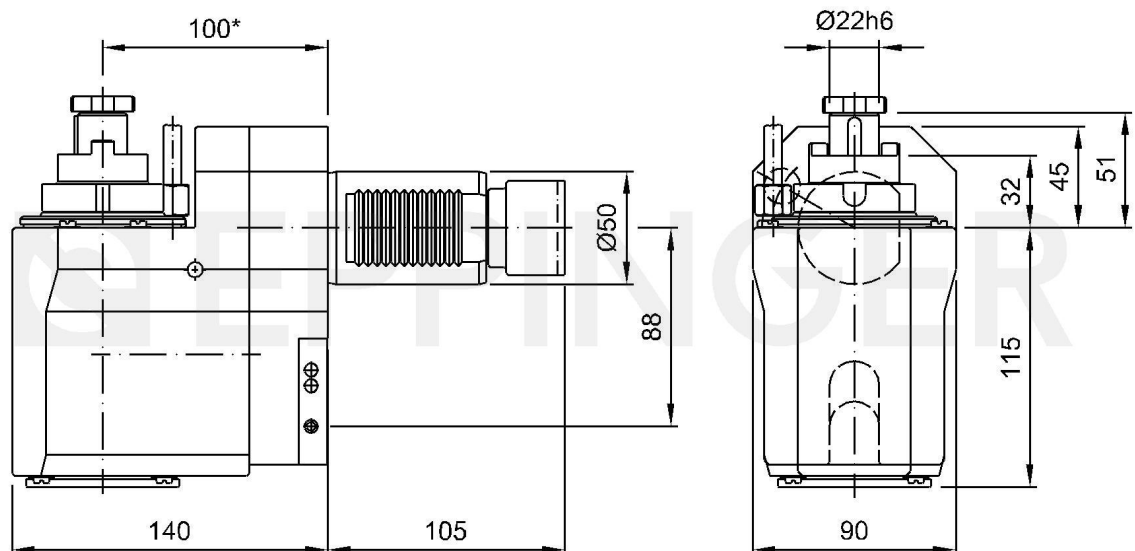

Milling head, angular, left hand, short
chuck for cutter arbor $\text{Ø}22$, external coolant supply

产品编号 9.836.191
适配 Okuma LB35II-M (bis Baujahr 05/2001)

传动比 1:1
输入转速 max. 4000 1/min
输出转速 max. 4000 1/min
输出扭矩 max. 100 Nm
旋转方向 
交货期 supplied with wrench, clamping bolt, driver ring
* Actual size inscribed on the tool



技术数据可能随时更新

28.07.2000 | 18.09.2012